

CROW
ENGINEERING



Acknowledgements

Crow Engineering wants to thank everyone who participated in this cooperative and collaborative effort:

- Morrow County Commissioners & Administrators
- Planning Department
- Justice Court
- Parole & Probation
- Sheriff Department
- Veterans Services
- Public Health
- Juvenile Department
- District Attorney/ Victims Assistance/ Child Support
- County Clerk
- City of Irrigon
- IT (Intermountain ESD)



CROW
ENGINEERING

Create The Right Vision

“Public Safety”
&
“Public Service”



CROW
ENGINEERING

Existing Conditions

Irrigon Annex – Approximately 2,360sf NET / 2,615sf GROSS

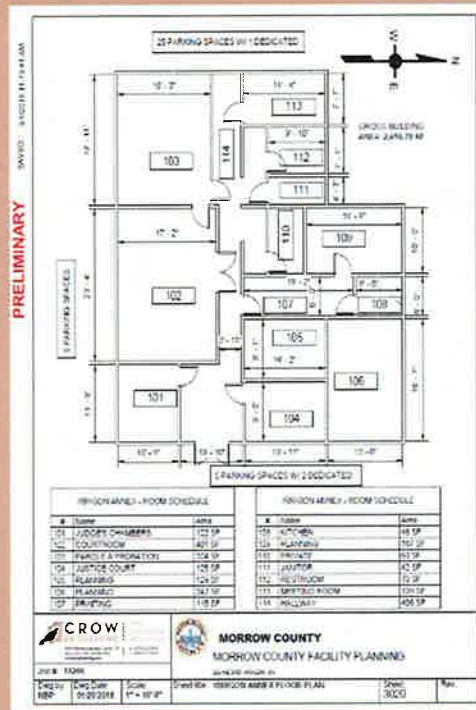

Existing Conditions

CSEPP Building – Approximately 1,118sf NET / 1,301sf GROSS

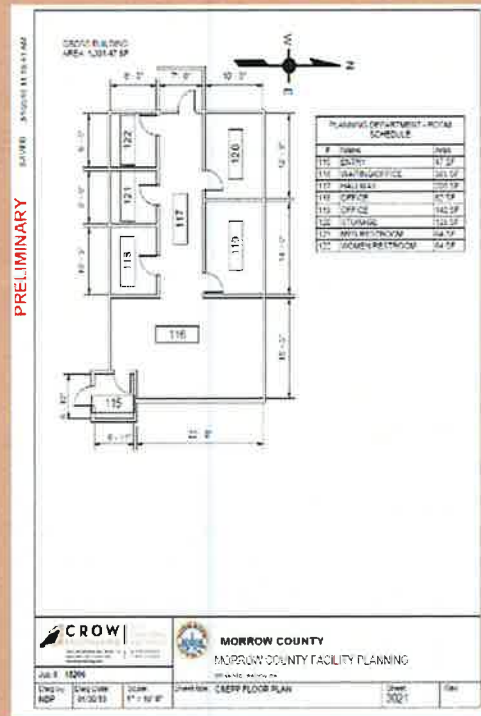

Existing Conditions

Irrigon City Hall – Veteran’s Services Office 194sf NET

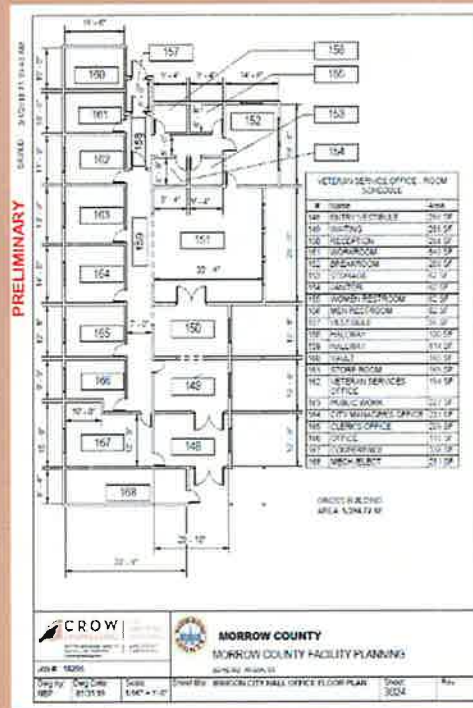

Existing Conditions

Irrigon/Boardman Assistance Center– County Clerk Office 145sf NET

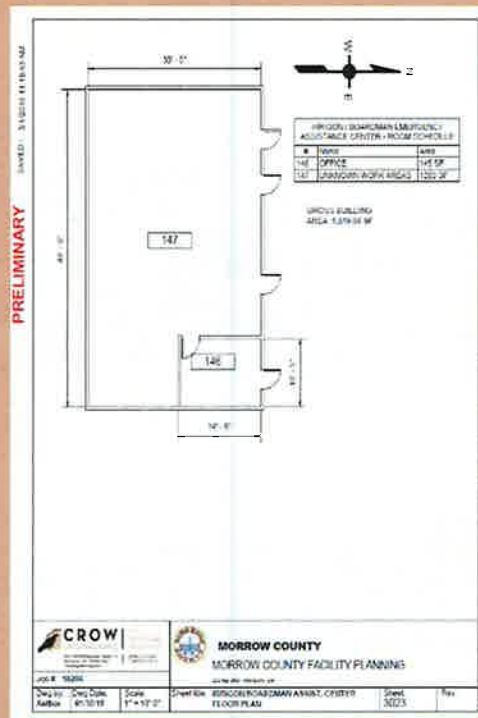

Existing Conditions

Boardman Clinic (Public Health, CARE, Juvenile, & District Attorney)

3,799sf GROSS / 3572sf NET

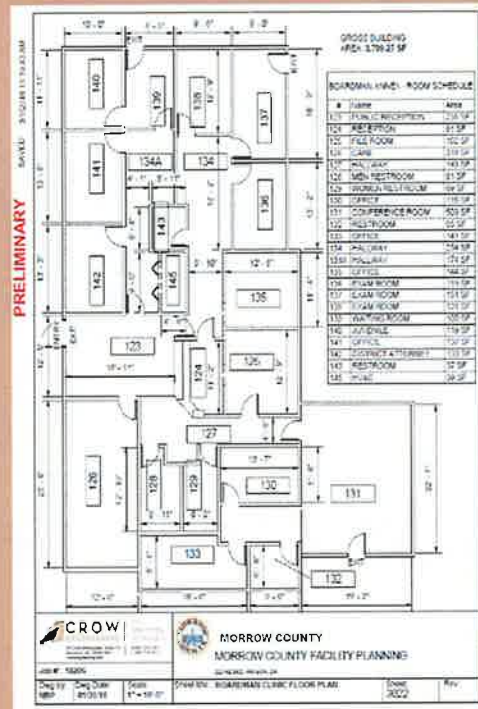

Growth Projections

County Department Growth Projection

Building	Department	Entire Department Staff	Staff at Location	10-Year Added Staff	20-Year Added Staff	30-year Added Staff	Existing SF	Public Served Daily	Existing Parking	Future Parking	Exterior Storage
Irrigon Annex	Planning	5	5	1	1	0	538	In person 6-12, Phone 6-12, Email 12-24	3rd St - 5 Spaces (2 dedicated), Main St- 6 Spaces, Rear- 25 Spaces (1 dedicated)	Irrigon Annex will be demolished for new Facility Parking	Boat, Fuel Cell, & County Work Vehicle
	Justice Court	3	3	1	0	0	648	40+/- in person/phone			
	Parole & Probation	4	4	1		0	324	Unknown			
	Shared Area (Meeting Room, Kitchen, Restroom, Janitor, Hallway)	NA	NA	NA	NA	NA	850	Misc. Area throughout facility			
Irrigon City Hall (1 Leased Office)	Veterans Services	1.5	1.5	0.5	0.5	0	194	1-6 in person	Shared parking with Irrigon City Hall	NA	NA
CSEPP Building & Boardman Substation	Sheriff	35	6-8	As County Grows			1301+	50+/- for entire county	Shared at Irrigon Annex	New parking area & covered secure parking	Boat, Fuel Cell, & County Work Vehicle
Boardman Clinic	Juvenile	1	1	1		0	220	Varies, 20 Case Loads	Shared with Boardman Clinic	Shared with Boardman Clinic	Shared with Boardman Clinic, external Storage shed
	District Attorney	5	1	0.5	0.5	0.5	270	Unknown			
	Public Health	10	10	1	1	1	3082	varies on day, season, and work load			
Irrigon Boardman Assistance Center (1 Leased Office)	County Clerk	1	1	0	0	0	151	6-13	Shared with rest of assistance center	Shared with rest of assistance center	Shared with rest of assistance center
Bartholomew Building	All										



CROW
ENGINEERING

Current State of Departments

PUBLIC SAFETY

- **Justice Court**



- Minimal waiting area
- Marginal ADA Compliance
- No separate staff/public restrooms
- Capacity issues
- Acoustic Issues
- Insufficient parking at times
- Marginal security measures



Current State of Departments

PUBLIC SAFETY

• Sheriff Department



- Marginal ADA Compliance
- No separate staff/public restrooms
- Acoustic Issues
- Marginal security measures
- No room for future growth
- Secure parking
- No Secure holding areas



Current State of Departments

PUBLIC SAFETY

- **District Attorney**



- Acoustic Issues
- Minimal secure storage
- Marginal security measures
- No secure shared print area
- No shared work area
- No room for growth



Current State of Departments

PUBLIC SAFETY

• Juvenile Department



- Shared waiting area
- Acoustic Issues
- Minimal secure storage
- Marginal security measures
- No secure shared print area
- No room for growth



Current State of Departments

PUBLIC SERVICE

• Planning Department



- No room for growth
- Capacity & space issues
- Minimal storage
- Marginal security measures
- Acoustics issues
- Inadequate parking on court dates
- No shared work space



Current State of Departments

PUBLIC SERVICE

• Veteran's Services



- Capacity & space issues
- No room for growth
- Lack of storage space
- Marginal security measures
- Acoustics issues
- No large work space area
- Must have secure printing



Current State of Departments

PUBLIC SERVICE

- **County Clerk**



- No room for growth
- Minimal waiting area
- Marginal security measures
- Acoustics issues



Future State of Departments

- Department & Commissioner collaboration
- Site location
- Understanding department Needs vs Wants
- Single facility operations & maintenance
- Department interdependencies
- New building construction
- Adequate parking for all departments
- Green initiative – Agreed upon 6%
- Options discussed



CROW
ENGINEERING

Future State of Departments

Preliminary Layout & Discussion

- 24,949sf single-story facility

Total Associated Cost

- \$5,625,742 to \$8,368,342

(Hard & Soft Construction Costs)

NEEDS
VS
WANTS



CROW
ENGINEERING

Construction Budgets

Construction of a new 15,779.25 sf county building

- **Hard Costs tied to Construction**
 - Low Index Cost $\$155/\text{sf} \times 15,779.25 \text{ sf} = \$2,445,783.75$
 - High Index Cost $\$240/\text{sf} \times 15,779.25 \text{ sf} = \$3,787,020.00$
- **Soft Costs tied to Construction**
 - \$70-95 per sf
 - $\$70/\text{sf} \times 15,779.25 \text{ sf} = \$1,104,547.50$
 - $\$95/\text{sf} \times 15,779.25 \text{ sf} = \$1,420,132.50$



CROW
ENGINEERING

Future State of Departments

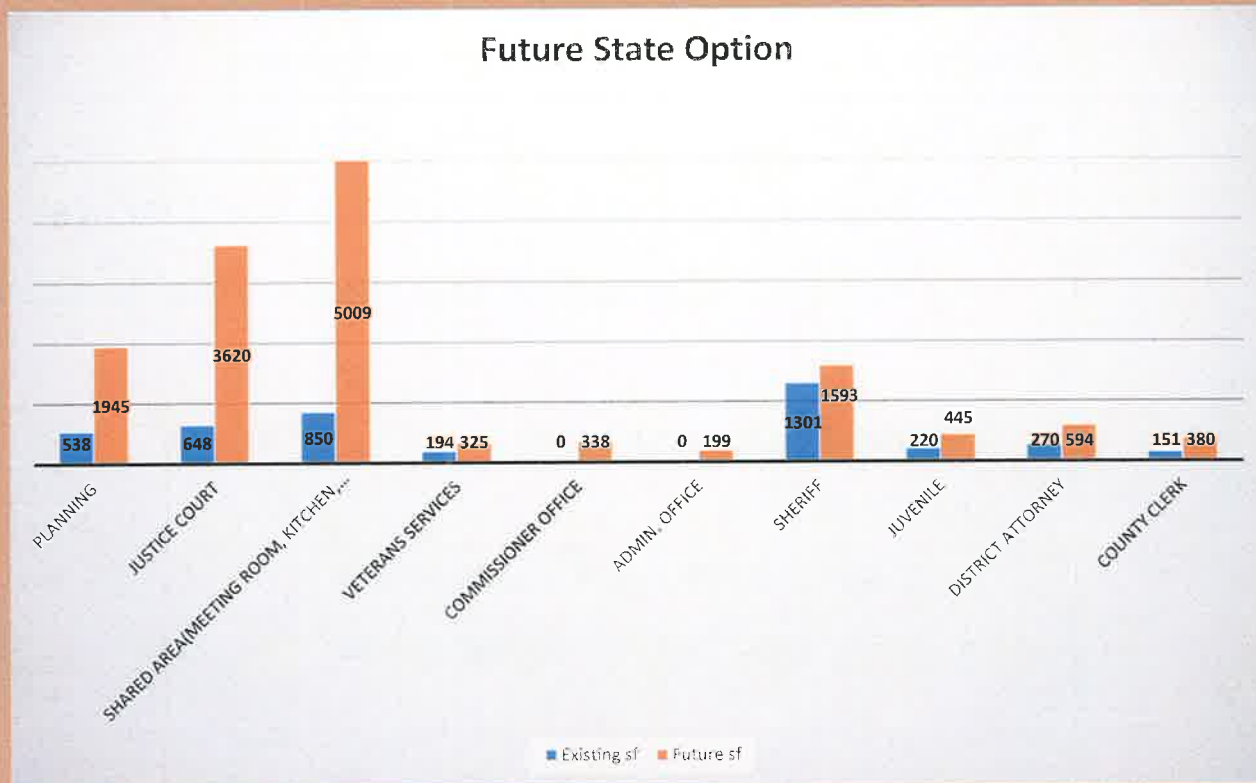

Based on NET sf



Overview

- Capturing the vision of “Public Safety & Public Service”
- Meet the county’s Needs for functionality
- Achieve the Goals set by the Commissioners and Crow Engineering
- Meet the county’s Needs for functionality
- Develop a conceptual layout to meet the budgetary requirements
- Provide understanding and planning for the Design & Engineering Phase



CROW
ENGINEERING

Questions



CROW
ENGINEERING

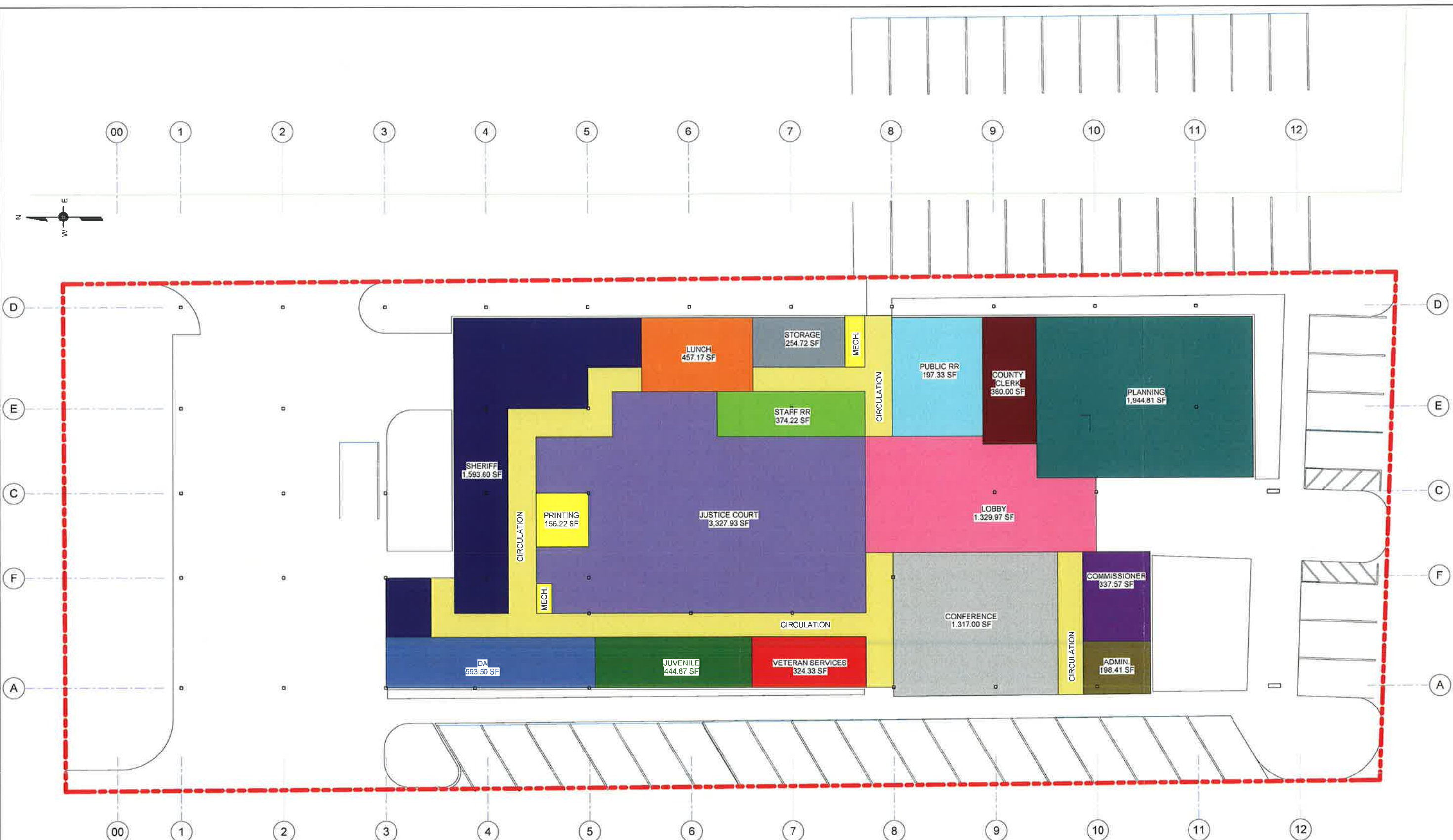

NEW BUILDING - OPTION 2A -
DEPARTMENT GROSS AREAS
1" = 10'-0"

THESE PLANS AND SPECIFICATIONS, AND THE ENGINEERING AND DESIGN WORK TO WHICH THEY PERTAIN, ARE INTENDED SOLELY FOR THE PROJECT SPECIFIED HEREIN. CROW ENGINEERING INC. DISCLAIMS ALL LIABILITY IF THESE PLANS AND SPECIFICATIONS, OR THE DESIGNS, ADVICE AND INSTRUCTIONS ATTENDANT THERETO, ARE USED ON ANY PROJECT OR AT ANY LOCATION OTHER THAN THE PROJECT AND LOCATION SPECIFIED HEREIN. THIS DRAWING IS THE PROPERTY OF CROW ENGINEERING INC. IT IS LOANED AND IS TO BE RETURNED UPON REQUEST. THE DESIGNS AND IDEAS SHOWN HEREON ARE THE PROPERTY OF CROW ENGINEERING INC. AND SHALL NOT BE REUSED, DISCLOSED TO OTHERS, OR COPIED, IN WHOLE OR IN PART, WITHOUT WRITTEN PERMISSION. COPYRIGHT 2018 BY CROW ENGINEERING INC. ALL RIGHTS RESERVED. THESE DRAWINGS DO NOT SHOW THE PRESENCE, LOCATION, POSITION, OR APPLICATION OF SAFETY DEVICES UPON OR SURROUNDING MACHINERY AND/OR EQUIPMENT. IT IS THE SOLE RESPONSIBILITY OF THE OWNER, MANUFACTURER AND/OR INSTALLER TO PLACE PROPERLY ALL SAFETY DEVICES UPON OR SURROUNDING MACHINERY AND/OR EQUIPMENT AND INSTRUCT THE OPERATORS UPON THE APPLICATION. THE CONTRACTOR SHALL PROVIDE ALL MATERIALS AND EQUIPMENT NECESSARY TO PROTECT THE STRUCTURE, WORKMEN AND OTHER PERSONS AND PROPERTY DURING CONSTRUCTION. THE CONTRACTOR IS RESPONSIBLE FOR THE OBSERVANCE OF ALL FEDERAL, STATE AND LOCAL SAFETY REGULATIONS DURING CONSTRUCTION.

No.	Date	Description	by



THIS DRAWING HAS BEEN RE-PLOTTED FROM A MODIFIABLE ELECTRONIC COPY AND THEREFORE IS NOT THE ORIGINAL DRAWING PREPARED BY CROW ENGINEERING INC. (ENGINEER). CHANGES OR ADDITIONS MAY HAVE BEEN MADE WITHOUT THE ENGINEER'S KNOWLEDGE OR CONSENT. THE ENGINEER WILL NOT ASSUME ANY LIABILITY FOR CHANGES MADE, NOR SHALL ENGINEER ASSUME ANY LIABILITY IF THIS DRAWING IS USED IN WHOLE OR IN PART FOR ANY PROJECT OTHER THAN THE PROJECT FOR WHICH THE DRAWING WAS ORIGINALLY PREPARED.



CIVIL
STRUCTURAL
MECHANICAL

MORROW COUNTY
203 NE 3RD, IRRIGON, OR
MORROW COUNTY BLDG
DEPARTMENT GROSS AREAS

DRWN	CHKD	SCALE	ISSUE DATE	PROJ NO - SHEET NO	REV
NBP	MEJ	1" = 10'-0"	05/29/18	3028	

PRELIMINARY 05-29-2018 NBP